

TECHNICAL NOTE

Date 18th Feb 19 (rev 3 Oct 21)

ref 440

Raised by: TC

Distributed to: as required

Soundtracs - Digico(UK) Ltd. unit 10 Silverglade Business Park Chessington Surrey KT9 2QL England
Tel: +44 1372 845600 Fax: +44 1372 845656 email: support@digiconsoles.com

SD5, SD10, SD7 MIXERS LCD Solo Button replacement types

In SD5 and SD10 have had various versions of LCD button over the product life.

The original buttons used for early SD5 (also SD10 smart keys) have been discontinued. Later mixers use, or have buttons that are compatible in style with, the SD7 button.

The basic difference is cosmetic and so we avoid mixing the 2 types on 1 panel.

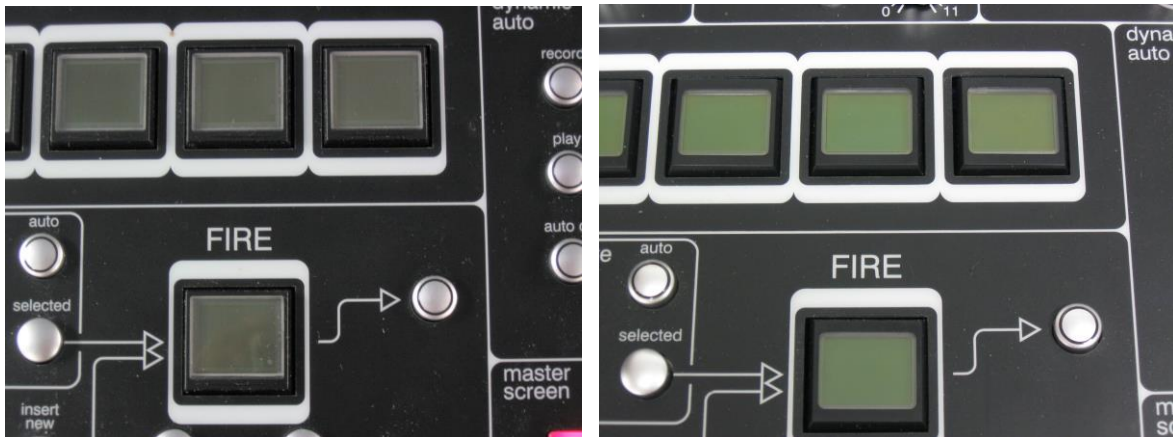

Early type SD5

Later/current type SD5

The current buttons for SD5 and SD10 are part number SW000116A .

These are also used on all SD7.

(This is an updated direct replacement for the SW000116 shown in some parts lists).

The old SD5 button looks different and is SW000121. These are no longer obtainable new. Note how the older button has a slimmer bezel (black edge around the window).

All buttons with the later style bezel can be replaced with SW000116A

Note on SD5 as the "fire" button is separate this can be swapped for the new pattern as this considered satisfactory cosmetically.

Otherwise, all SD5, SD10 and SD7 repairs are covered by SW000116A.